

Reference : C-25H25 830-8+F

The Fixolite box is a 6 m long prefabricated lintel box designed to receive a closure (roller shutter, BSO, etc.). The box consists of an inverted U-shaped, fire-retardant expanded polystyrene (30 kg/m³ density) shell reinforced with steel mesh. The side walls are fitted with aluminum rails.

Traditional model box

The most economical solution while still offering good performance.

Certified by a Technical Approval from CSTB.

Maximum length: 160 cm structural opening (184 cm overall).

Packaging: pack of 28 (or 56) boxes, 6 ml each.

Type	25H25
Outer rail ref.	830
Inner rail ref.	827
Color	Blue polystyrene
Compatible cheek	J-25
Certification	CSTB 16-11-634 (translated) [PDF]
Thermal conductivity	U = 1.0 W/m ² .K
Thermal resistance*	R = 1.0 m ² .K/W

(* R: thermal resistance (m².K/W) taking into account a λ coefficient of 0.0374 W/m.K after application of a safety coefficient of 1.15.

Weight	2.82 kg/m
Reaction to fire	class E (EN ISO 11925-2/EN 13 501)
Air permeability	c*3 class
Acoustic perf. (Dn _W)	49 dB

Box dimensions

Width	245 mm
Height	245 mm
Tunnel	196 mm
External side	25 mm
Internal side	25 mm

Components

Wood-cement fiber	0.97 kg/m
Aluminium (recycl. 85%)	0.58 kg/m
Steel (recycl. 96.5%)	0.72 kg/m
Polystyrene (recycl. 10%)	0.55 kg/m
Total	2.82 kg/m

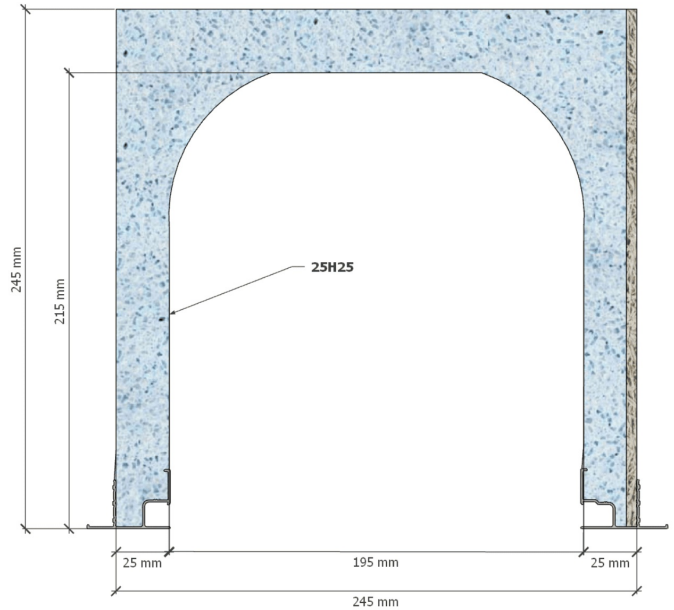

Sides finishing

External side
Wood-cement fiber



Internal side
Ribbed polystyrene



Rail diagram

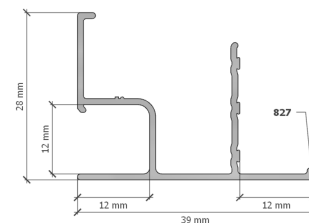
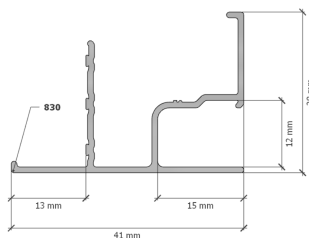

English



Français



2025-11 • Fixolite Disclaimer. The information provided in this technical sheet is for reference only and without warranty of accuracy or completeness. Fixolite disclaims any liability for errors, omissions, or consequences related to the use of this information. Specifications are subject to change without notice.

Check out our [installation instructions \[PDF\]](#) and [general documentation](#)